



Harpley Square, London, , E1 4ES £375,000

Elms Estates are delighted to offer For Sale this THREE bedroom maisonette in Harpley Square with its very own balcony.

Harpley Square is located just off of Globe Road, offering good access to both Bethnal Green (Central Line) and Stepney Green (District Line) stations, along side multiple bus routes heading into Central London and beyond.

Internally the property is split over two levels with the ground floor having a large reception room, balcony and separate kitchen. On the first floor you will find three well proportioned bedrooms and bathroom. The property also boasts a private garden to the rear of the block.

An early appointment is recommended to avoid disappointment.



Reception Room
15'8" x 13'5" (4.80 x 4.11)

Kitchen
11'6" x 8'5" (3.51 x 2.57)

Bedroom One
14'6" x 8'5" (4.42 x 2.57)

Bedroom Two
13'8" x 8'7" (4.17 x 2.64)

Bedroom Three
10'5" x 6'9" (3.20 x 2.06)

Bathroom

Balcony

Material Information

Tenure: Leasehold
Length Of Lease: Approx 86 Years remaining
Annual Ground Rent: £10.00 Per year
Annual Service Charge: £1,442.33
Council Tax Band: C

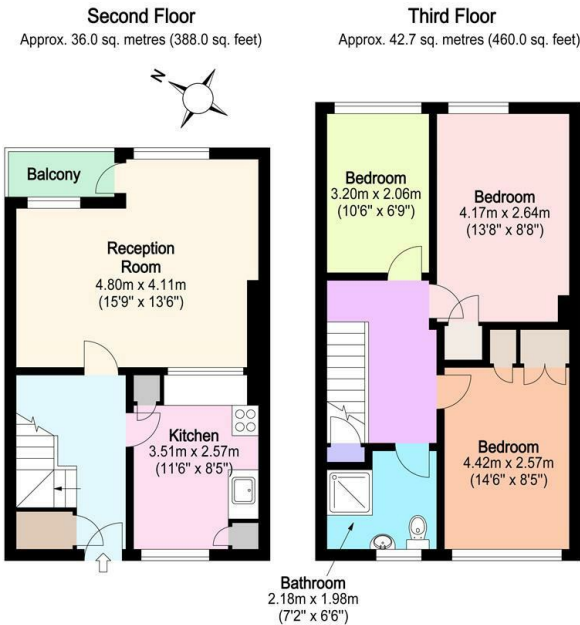

Total area. approx. 78.7 sq. metres (848.0 sq. feet)
For illustration purposes only - not to scale

